

REV.	DATE	DESCRIPTION
A	01/07/04	REFORMAT DRAWING

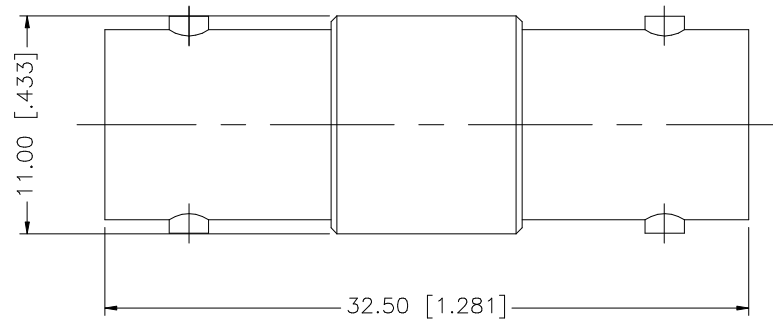

8					<small>UNLESS OTHERWISE SPECIFIED DIMENSIONS ARE IN MILLIMETERS, DIMENSIONS IN [] ARE IN INCHES AND FOR CUSTOMER REFERENCE ONLY.</small> <small>UNLESS OTHERWISE SPECIFIED TOLERANCES FOR MILLIMETERS ARE:</small> 0.5 - 8mm ± 0.20mm 8 - 30mm ± 0.40mm 30 - 120mm ± 0.50mm <small>UNLESS OTHERWISE SPECIFIED TOLERANCES FOR INCHES ARE:</small> .020 - .315 = ± 0.007" .315 - 1.180 = ± 0.015" 1.180 - 4.724 = ± 0.020"	APPROVALS	DATE	<h1 style="color: blue;">Amphenol Connex</h1>						
7						DRAWN	G.R.S.				01/07/04			
6						CHECKED			PART DESCRIPTION					
5						ISSUED			BNC FEMALE TO FEMALE ADAPTER 75ohm					
4						SHEET	1 OF 1		PART NO.					
3	CONTACT PIN	PHOS. BRONZE	GOLD	1				112446						
2	INSULATOR	DELTRIN	NATURAL	1				DWG. NO.						
1	BODY	BRASS	NICKEL	1				112446.DWG						
	DESCRIPTION	MATERIAL	FINISH	QTY	DO NOT SCALE DRAWING	CAD FILE	C:/112/112446.DWG		REV.	A	SIZE	A	SCALE	NA